



### Main features

- Temperature limits: - 40 ... + 300° C
- Tolerance: UNI 7937, IEC 751 standards:  
 $\pm 0.15^\circ\text{C}$  a  $0^\circ\text{C}$  for class A (1/2 DIN)  
 $\pm 0.30^\circ\text{C}$  a  $0^\circ\text{C}$  for class B (1 DIN)  
 $\pm 0.10^\circ\text{C}$  a  $0^\circ\text{C}$  for class 1/3 DIN
- Ceramic insulation of sensor, PT100 at  $0^\circ\text{C}$
- Application versatility

### MODELS

**TR6 A**  
without fitting

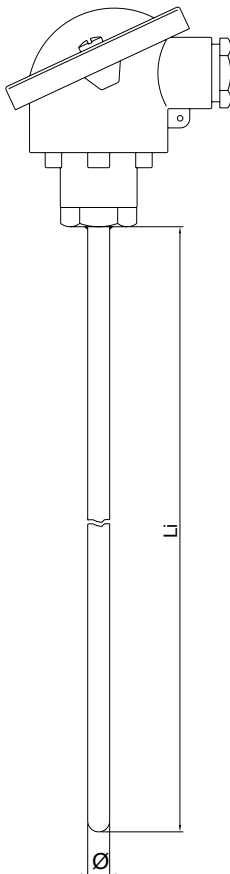

**TR6 B**  
with adjustable  
compression fitting

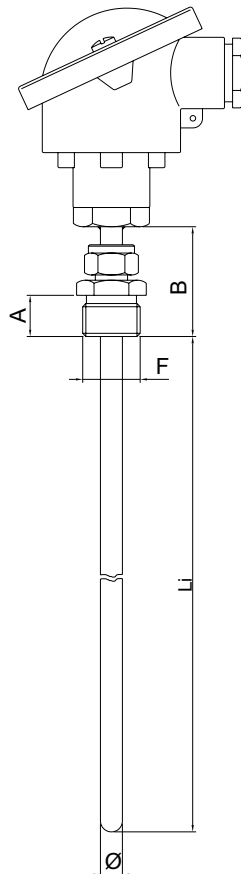

**TR6 C**  
with welded fitting

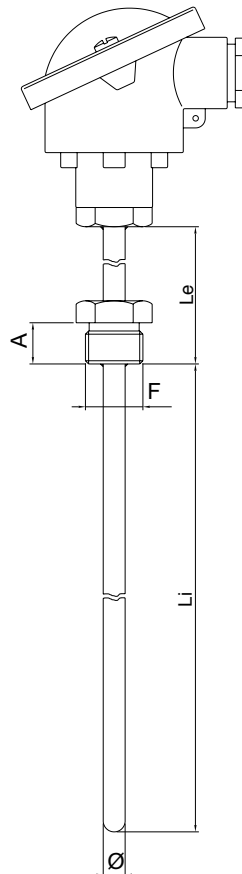

**TR6 D**  
with welded fitting  
under the head

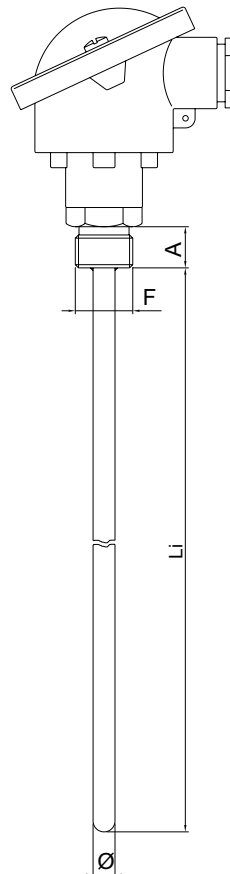

**TR6 E**  
with female fitting  
and welded ring

